

SITE NOTES

1. ALL DIMENSIONS ARE TO FACE OF CURB UNLESS OTHERWISE NOTED.
2. ALL RADII SHALL BE 4' UNLESS OTHERWISE NOTED.
3. ALL WORK SHALL BE DONE IN STRICT ACCORDANCE WITH DIVISION 2 OF LOWE'S STANDARD SITE SPECIFICATIONS.

NORFOLK & SOUTHERN RAILROAD RIGHT-OF-WAY

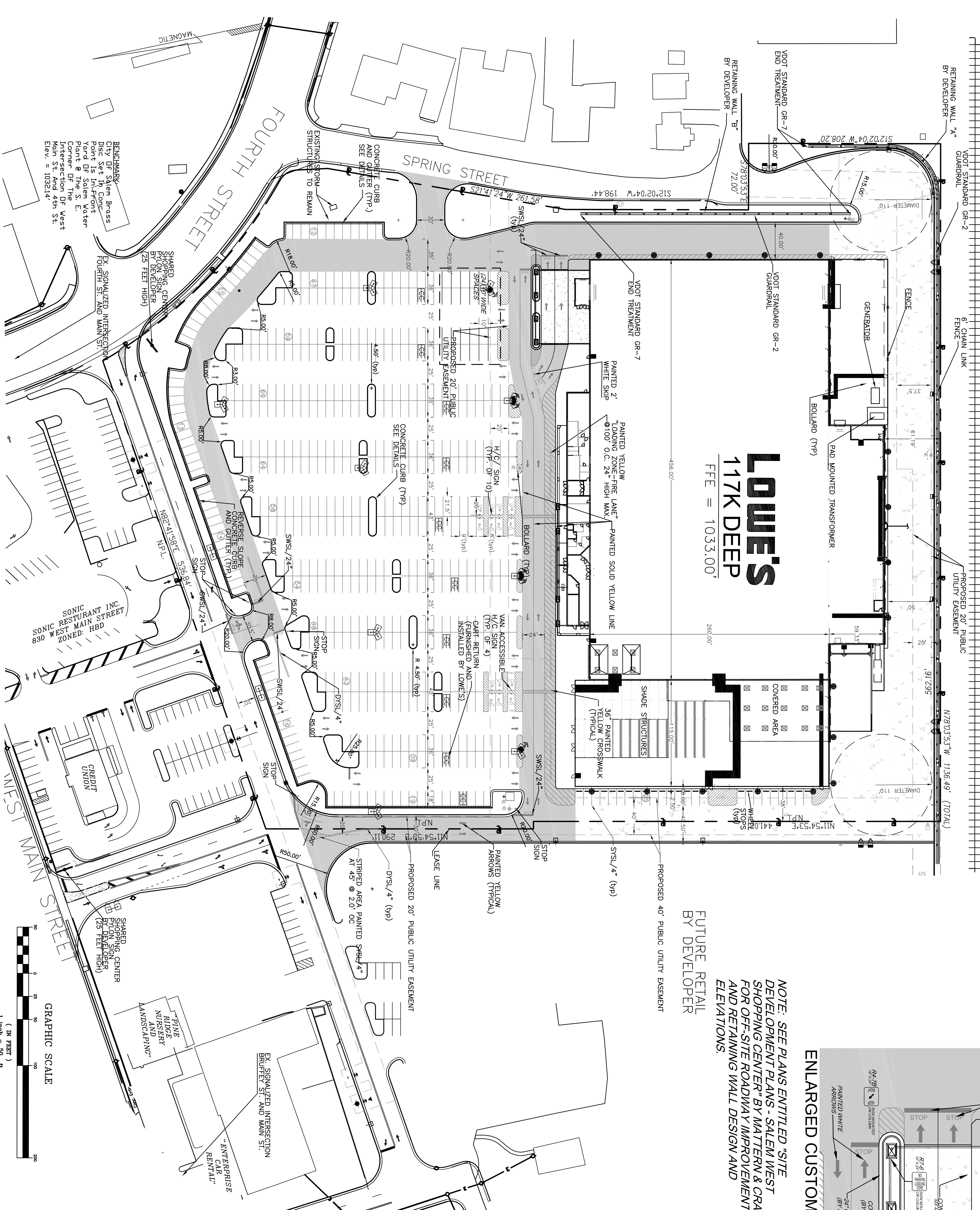

LOWE'S
17K DEEP
FFE = 1033.00'

FUTURE RETAIL
BY DEVELOPER

NOTE: SEE PLANS ENTITLED "S/SITE DEVELOPMENT PLANS - SALEM WEST SHOPPING CENTER" BY MATERN & CRAIG FOR OFF-SITE ROADWAY IMPROVEMENTS AND RETAINING WALL DESIGN AND ELEVATIONS.

ENLARGED CUSTOMER CANOPY DETAIL SCALE = 1:20

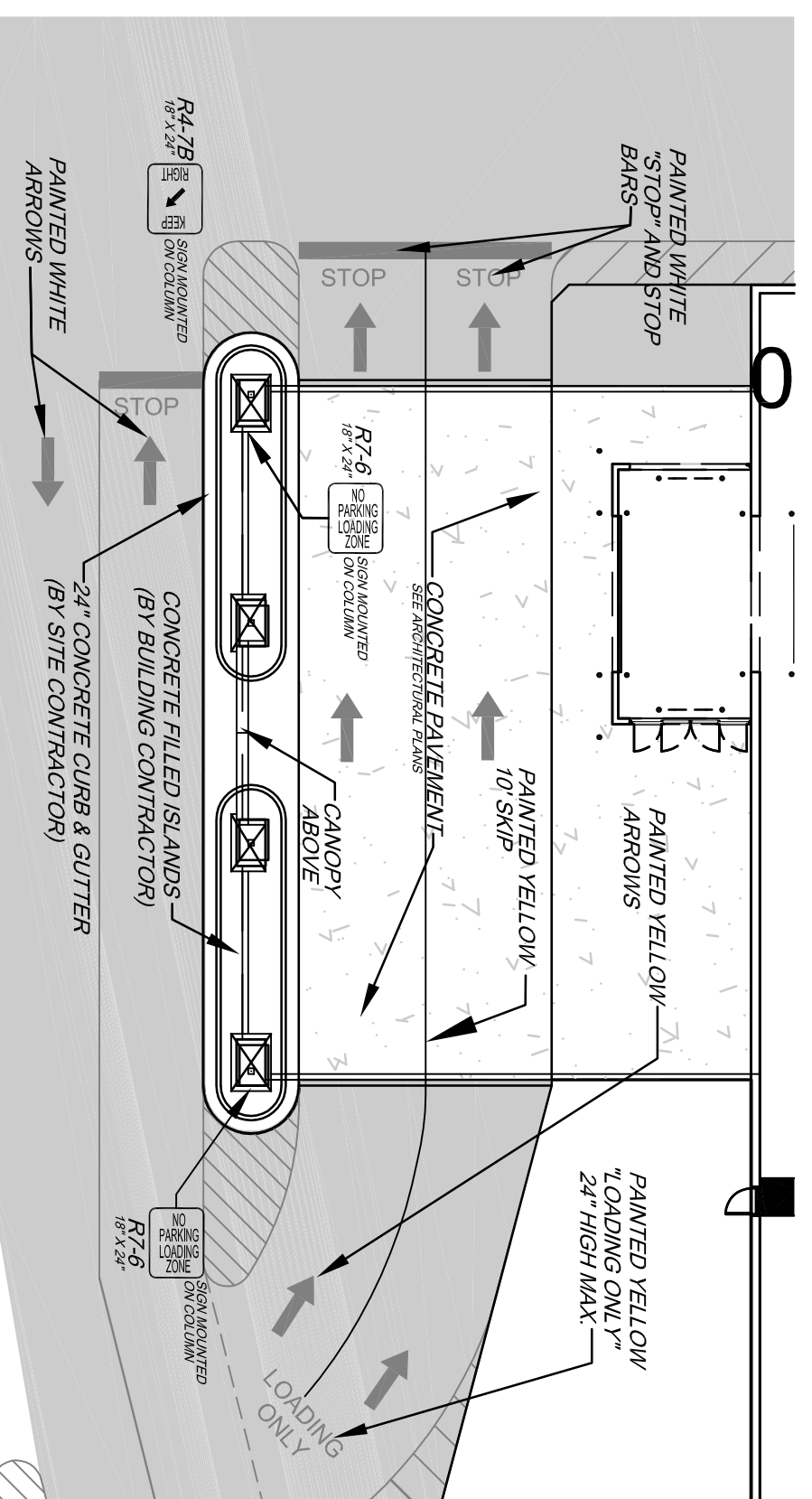

PAINT STRIPING LEGEND

- SMSL/24" - SINGLE WHITE SOLID LINE /24" WIDE
- SMSL/4" - SINGLE WHITE SOLID LINE /4" WIDE
- SMSL/4" - SINGLE WHITE DASHED LINE /4" WIDE
- DVSL/4" - DOUBLE YELLOW SOLID LINE /4" WIDE EACH

SITE DATA

Acres:	12.75 AC
Lowe's Tract	12.75 AC
Total	12.75 AC
Main Building:	118,560 S.F.
Sales Floor	3,937 S.F.
Office Area	13,528 S.F.
Receiving/Storage	1,378 S.F.
Utility Rooms	2,007 S.F.
Vestibules:	2,007 S.F.
Total	139,410 S.F.
MAIN BUILDING TOTAL	139,410 S.F.
Garden Center:	8,422 S.F.
Shade Structures	8,644 S.F.
Covered Area	14,593 S.F.
Open Area	31,659 S.F.
Garden Center Total	54,874 S.F.
Non-Covered Area	10,581 S.F.
Total Staging Area	10,581 S.F.
Parking Requirements:	
Lowe's Parking Required:	615
Standard	13
Handicapped	628
Total Parking Required	641
Local Parking Required	546
Standard	12
Handicapped	558
Total Parking Required	570
Parking Provided:	577
Standard	14
Handicapped	591

LEGEND

- HEAVY DUTY ASPHALT PAVEMENT SECTION
- STANDARD DUTY ASPHALT PAVEMENT SECTION
- HEAVY DUTY CONCRETE PAVEMENT SECTION
- CONCRETE CURB & GUTTER
- REVERSE SLOPE CONCRETE CURB & GUTTER
- CART RETURN
- BUILDING LIMITS
- CHAIN LINK FENCE
- GUARDRAIL
- RETAINING WALL
- LIGHT POLE/SIGNALS
- 100 YEAR FLOOD ELEVATION = SUBJECT PROPERTY NOT IN 100 YEAR FLOOD PLAN PER FLOOD INSURANCE RATE MAP PANEL 5116(I)137 G, PANEL 137 OF 310, EFFECTIVE DATE SEPTEMBER 28, 2007

SITE PLAN

LOWE'S OF SALEM, VIRGINIA

PROJECT No: 50006082 | DRAWN BY: MAT | CHECKED BY: BKB



Dewberry & Davis, Inc.
A Dewberry Company

PRELIMINARY

NO.	DATE	DESCRIPTION

C2